



Innovation
Pat. pendings
Inventor

AIDIMA HOUSE, PLYWOOD, BASIC SIZE

20060592 ja 20060777
Martti Hotti

For Sale
Contact

The total innovation and business idea as a global production and marketing license.
Veikko Saksi (contact information below)

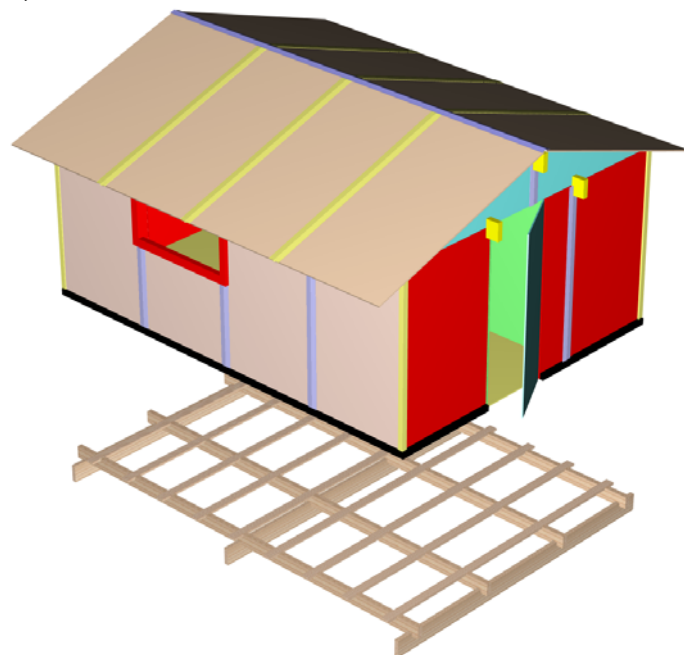
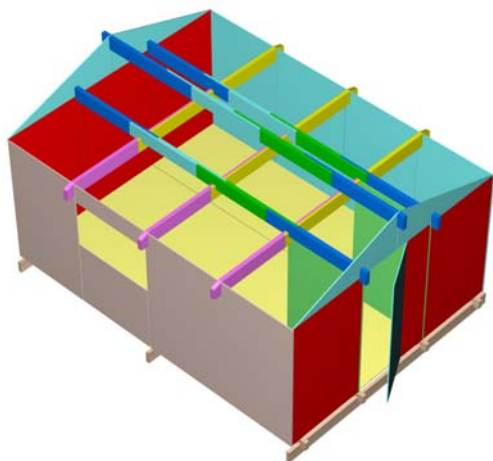

Use

First accommodation and service building for emergency, disaster, earthquake, flood, hurricane and similar districts. House for refugees and homeless people. Warehouse, garage, summer house.

Materials

Walls and floor: film coated spruce or mixed plywood Footing: logs 150 x 35 mm and 200 x 35 mm
Roof: film coated spruce or mixed plywood 15 mm. Doors and pediments: film coated spruce or mixed plywood 35 mm.

Wall elements 1 200 x 2 000 mm: 14 pc, 8 pc which have been cut for the purlin wood
Floor, plywood 1 200 x 2 400 mm: 6 pc
Plywood for roof 1 200 x 2 300 and 1 350 x 2 300 mm: for both 4 sheets
Door element, window, lower and upper parts of the windows, pediments

Heat treated wood: 60 x 200 x 2 400: 6 pc/house
60 x 150 x 2 700: 8 pc/house
25 x 100 x 1 300: 27 pc/house

Crossbeams 30 x 200 mm plywood, 2 700 mm 6 pc/house, 1 220 mm 6 pc/house
Wedge beams 1 600 mm: 6 pc and 1 100 mm: 6 pc

Hinge: house 80 m, box 20 m
Axis of the hinge: 14 mm mounting pipe

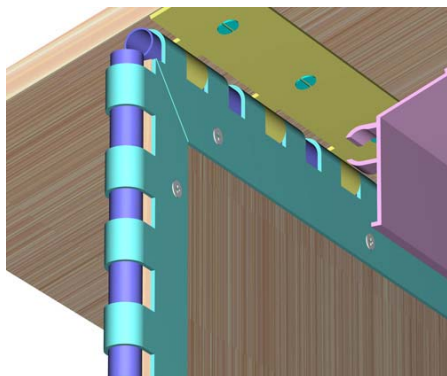

Images: hinges



Plastic parts, polypropylene 100 x 300 mm: about 320 pc/house. Window polycarbonate.
Joining bolts 12 x 75 mm: cross section logs (3 x 18 pc = 48 pc), crane logs (3 x 32 pc = 96 pc), upper logs for the base (4 x 18 pc = 72 pc), lower logs for the base (3 x 16 pc = 48 pc), total bolts 264 pc.

Characteristics

Foundation pillars: 9 pc. Fine adjustment in the floor if needed. Well wind insulated system. In-door measurements: 3 600 x 4 800 mm. Indoor height of the ridge 2 500 mm, height of wall 2 000 mm.

Mounting and striking time with a 5 men team: 3 – 4 hours, no need of special tools. A team pre-makes corner and strutting points f. ex. of bricks.

Transportation box, 15 mm, plywood: 2 800 x 1 400 x 700 mm, weight with the box about 1 000 kg

Cost

Need of material/house: heat treated spruce 0.6 m³, plywood 1.6 m³. Hinge material 2 x 145 mm zinc steel.

Price estimate VAT 0 %: planed, heat treated spruce 380 €/m³, plywood 400 €/m³.

Material cost: footing planks 0.6 m³ x 400 €, plywood 1.6 m³ x 400 €, transportation box 0.21 m³ x 400 €, hinges 3 €/m, other (window, doe, adjustment of floor) total 250 €. Plastic elements, polypropylene 100 x 300 x 2 mm, 1,5 €/kg, weight of element 60 g.

Cost of work depends of the volume: 50 - 80 €/house.

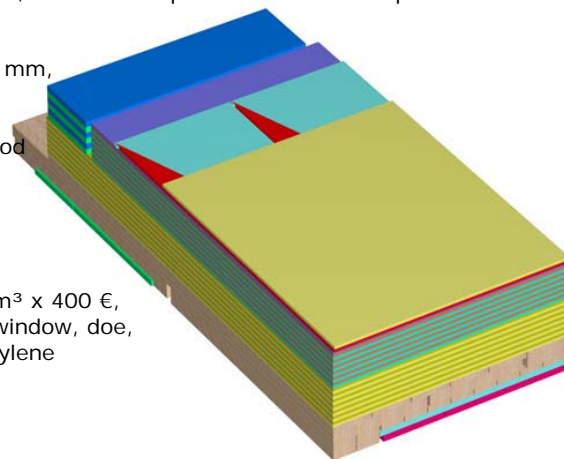

Image: transportation package

Production lines

Plywood for the floor 1 200 x 2 400 mm: 6 pc, working time for one pc: 20 sec. Workers 2.

Plywood for the roof 1 200 x 2 300 and 1 350 x 2 300 mm: both 4 widths. Two production lines, working time for both 20 sec. Two workers on the line.

Wall elements 1 200 x 2 000 mm: 14 pc, 8 pc cut for the beam. Two lines, working time for a sheet 20 - 30 sec. Both lines have two workers.

Door element and window and lower and upper sides of the window, pediments. Three workers, Additional materials in about 5 minutes.

Speed of handling footing planks (cutting + drilling), on the average 15 sec/pc, workers on the line 2.

Assembling of boxes: 50 houses/2 workers/8 h.
Packing line: on the average 10 houses/worker/8 h.
Basic poles: local subconstruction and mounting.

Semi-detached house

